

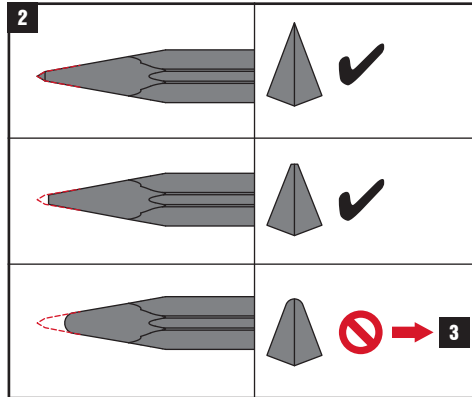

# re-shape chisels

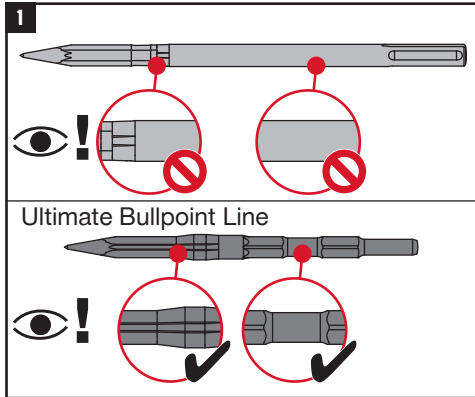

2496576-2026.03.27



**3**

Type	L0 [mm/inch]	L1 [mm/inch]
TE-HX17 BP28	280/11	>190/7.5
TE-YX BP36	360/14.1	>290/11.4
TE-SX BP36	360/14.1	>260/10.2
TE-SX BP50	500/19.7	>400/15.7

